

SECTION A-A

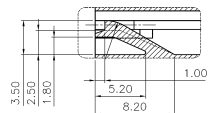

DETAIL 'B', (S=4:1)

A

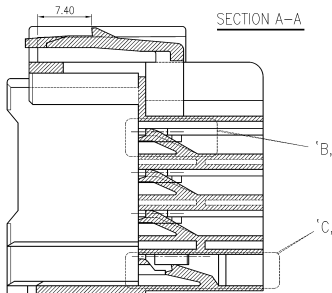
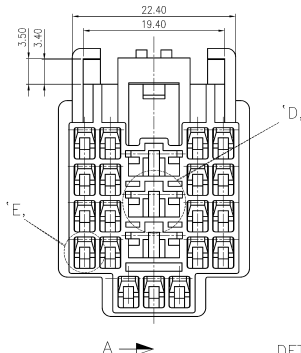

DETAIL 'D'

DETAIL 'E', (S=10:1)

NOTE

1. 지시하지 않은 모든 전봉 0.3으로 한다.
2. 직물가능성 유해한 BURR, 변형 및 WELDLINE 등이 없을것.
3. 사용 TERMINAL: ST 74025,3,254,255( 250TYPE : 3 EA )  
ST 740484,485(070TYPE : 19 EA )
4. 사용 HOUSING: MG 610837



		(MATERIAL)		PBT		KET		KOREA ELECTRIC	
		(PROCESS)		NATURAL		TERMINAL CO., LTD.			
		(FINISH RANGE)				(CLASS)			
		(INSULATION)				(TYPE)			
LRP	(REFUSION RECORD)	DR	CHK	DATE	TEMPERATURE	MOULD	(NO.)	MG620838	
DR	RHO.94.10.24	DR	CHK		±0.2	3/1	(NO.)	MG620838	
CHK	5월 2일	APP	4/22		(MARK)			2507 REC' HOUSING 22P	