

GENERAL TOLERANCE (HOUSING)					USED ON
10MAX	20MAX	45MAX	ANGLE	ECCENT	
±0.2	±0.25	±0.3	±30'	0.1	

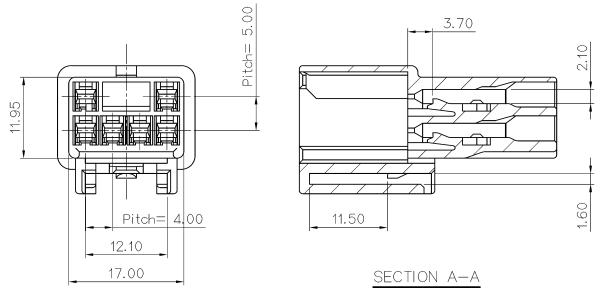
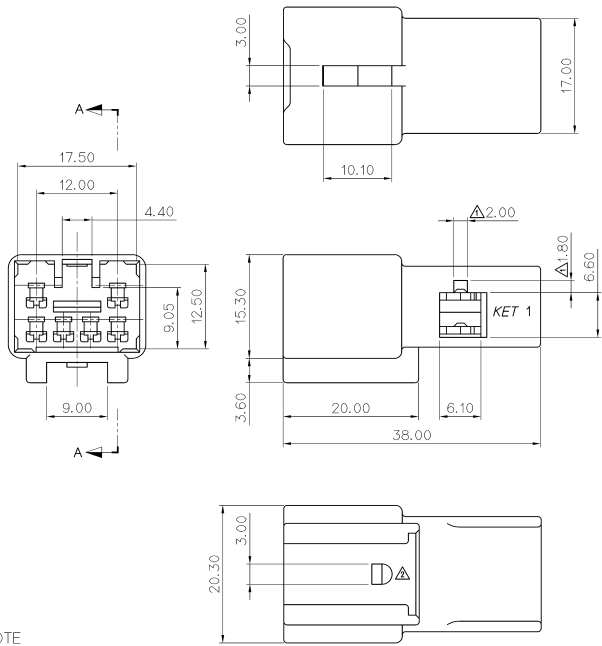

NOTE

- MUST BE FREE OF BURR, WELDLINE AND IMPERFECTION THAT AFFECT FUNCTION.
- APPLICABLE TERMINAL: ST740672, 673, 674
APPLICABLE HOUSING: MG612228, 651044
APPLICABLE SPACER: MG632230
APPLICABLE CLIP: MG631267, 631268, 631471, 632019
- 6 HAZARDOUS SUBSTANCES IN PARTS (LEAD, MERCURY CADMIUM, HEXAVALENT CHROMIUM, PBBs, PBDEs) SHALL NOT EXCEED THE MAXIMUM PERMISSVLE CONCENTRATION PRESCRIBED UNDER EU ELV DIRECTIVE & RoHS REGULATION.

주 기

- 기능상 유해한 BURR 및 WELDLINE 등이 없도록.
- 적용 TERMINAL: ST740672, 673, 674
적용 HOUSING: MG612228, MG651044
적용 SPACER: MG632230
적용 CLIP: MG631267, 631268, 631471, 632019
- 제품내 함유된 6대 유해물질 (납, 수은, 카드뮴, 6가크롬, PBBs, PBDEs)은 EU ELV 지침 및 RoHS 법규에서 지정한 최대 허용 농도를 초과해서는 안된다.



ISSUE MARK

				MATERIAL PBT		KET KOREA ELECTRIC	
				FINISH NATURAL		TERMINAL CO., LTD.	
△ #기재번호(020800080)이거 재작성		KHS		2008.4.02		CLASS .090	
△ SPACER 오조립 방지		SWS		2002.5.29		TYPE	
LTR REVISION RECORD		DR		DATE		PART NO. MG62229	
DR. WON. 2002.4.11		CHK		4/15		SCALE 2/1	
CHK		APP. 최은희		4/15		PART NAME	
						ASC 06M HOUSING	