

NO.	PART NO.	PART NAME	MATERIAL	FINISH
1	MG673391	LIF 39M HOUSING	PBT	BLUE
2	MG673176	LIF 39M SPACER		GRAY

GENERAL TOLERANCE (HOUSING)							USED ON
10MAX	50MAX	100MAX	250MAX	250VR	ANGLE	ECCENT	
±0.2	±0.3	±0.55	±0.95	±1.4	±30'	0.1	

주 기

- 기능상 유해한 BURR 및 WELDLINE 등이 없을 것.
- 적용 TERMINAL(090): ST740672, 673, 674
적용 TERMINAL(040): ST740771, 959
적용 HOUSING: MG653390, 3565
적용 WIRE COVER: MG633422
- SPACER는 1차 조립 상태를 유지 할 것.
- 제품내 함유된 6대 유해물질 (납, 수은, 카드뮴, 6가 크롬, PBBs, PBDEs)은 EU ELV 지침 및 RoHS 법규에서 지정한 최대 허용 농도를 초과해서는 안된다.

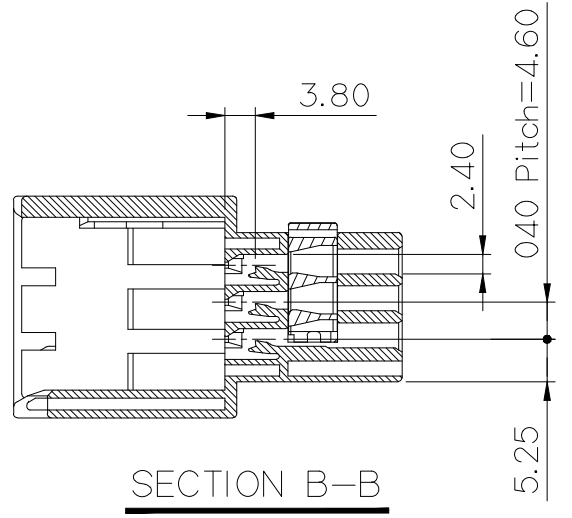
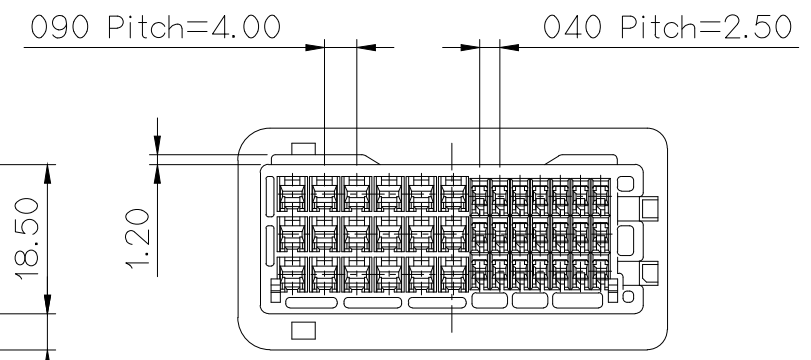

NOTE

- MUST BE FREE OF BURR, WELDLINE AND IMPERFECTION THAT AFFECT FUNCTION.
- APPLICABLE TERMINAL(090) : ST740672, 673, 674
APPLICABLE TERMINAL(040) : ST740771, 959
APPLICABLE HOUSING : MG653390, 3565
APPLICABLE WIRE COVER : MG633422
- SPACER MUST BE KEEP AND SUPPLY
- FIRST LOCKING CONDITION AS THIS DRAWING
- 6 HAZARDOUS SUBSTANCES IN PARTS (LEAD, MERCURY, CADMIUM, HEXAVALENT CHROMIUM, PBDEs) SHALL NOT EXCEED THE MAXIMUM PERMISSIBLE CONCENTRATION PRESCRIBED UNDER EU ELV DIRECTIVE.

APPROVED

2017-08-10

KOREA ELECTRIC
TERMINAL CO., LTD.
Korea Electric Terminal Co., LTD.

ISSUE MARK

△4	설계시양변경(S050059)근거 도면 제작성 (삽입성 개선 위한 GUIDE부 형상변경)	KDJ	HEO	K.J. KIM	2006.02.16	MATERIAL	SEE TABLE	KOREA ELECTRIC TERMINAL CO., LTD.
△3	설계시양변경(S050300)근거 도면 제작성 (이중 LOCK G를 개선 GUIDE 형상 변경)	KDJ	HEO	K.J. KIM	2005.12.26	FINISH	SEE TABLE	
△2	시방변경(S040175)근거 도면 제작성	KDJ	KKJ	KCH	2004.11.10	WIRE RANGE	CLASS	ASC + 040III
△1	고지리 개선(040III 단자 홈 방지)	KDJ	KKJ	KCH	2004.9.24	INSULATION	TYPE	
LTR	REVISION RECORD	DR.	CHK.	APP.	DATE	TOLERANCE EXCEPT AS NOTED	SCALE	PART NO.
DR.	KDJ. 2004.06.16	CHK.				SEE TABLE	1/1	MG643392
CHK.	KKJ	APP.	KCH			PART NAME	LIF 39M HOUSING ASSY (B TYPE)	