

ISO VIEW

GENERAL TOLERANCE (HOUSING)										USED ON
10MAX	30MAX	50MAX	70MAX	100MAX	120MAX	250MAX	250VR	ANGLE	ECCENT	
±0.15	±0.2	±0.3	±0.4	±0.5	±0.75	±0.9	±1.4	±30'	0.1	

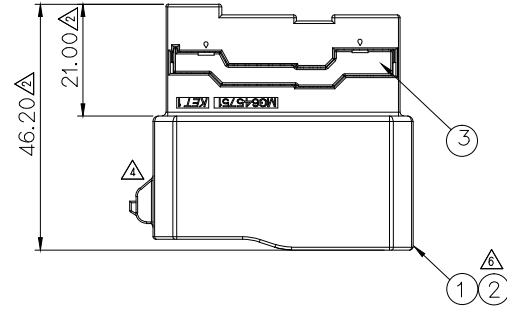

025060110250 47M ASSY		025060110250 47M ASSY_B	
PART NO.	MG645751	PART NO.	MG646332

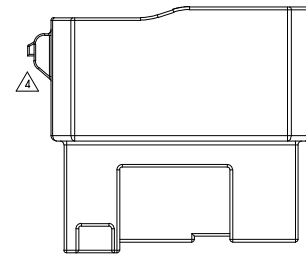
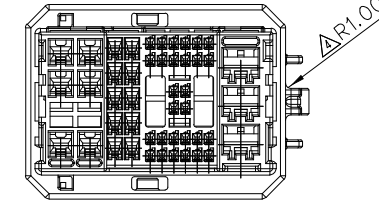
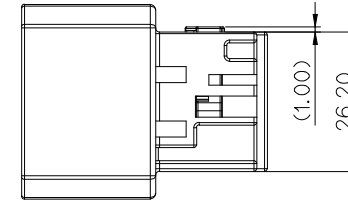
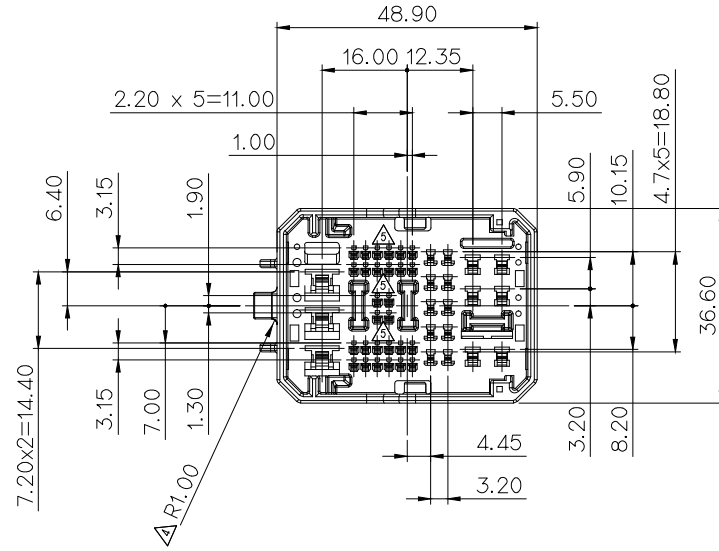
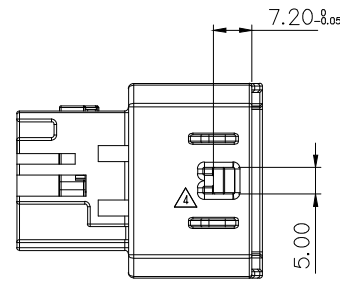

NO.		PART NAME	PART NO.	MATERIAL	COLOR
①	1	025060110250 47M HOUSING	MG675888	PBT	NATURAL
②	-	025060110250 47M HOUSING_B	MG677512	PBT	NATURAL
③	1	025060110250 47M SPACER	MG675889	PBT	L/GRAY

주 기

- 가능상 유해한 BURR 및 WELDLINE 등이 없을 것.
- 적용 TERMINAL(025II) : ST741345,741346
적용 TERMINAL(060) : ST741331,741332,741333,△741411,△741405
적용 TERMINAL(110) : ST741285,741286,741287,△741373
△ST741408,△741407,△741418
적용 TERMINAL(250) : ST741206,741207,741208,△741455
△ST741417,△741416,△741415
적용 CONNECTOR : MG655703
△적용 CLIP : 090II CLIP
- 제품내 함유된 6대 유해물질 (납,수은,카드뮴,6가크롬, PBBs,PBDEs)은 EU ELV 지침 및 RoHS 법규에서 지정한 최대 허용 농도를 초과해서는 안된다.

NOTE

- MUST BE FREE OF FLASH, WELDLINE AND IMPERFECTION THAT AFFECT FUNCTION.
- APPLICABLE TERMINAL(025II) : ST741345,741346
APPLICABLE TERMINAL(060) : ST741331,741332,741333,△741411,△741405
APPLICABLE TERMINAL(110) : ST741285,741286,741287,△741373
△ST741408,△741407,△741418
APPLICABLE TERMINAL(250) : ST741206,741207,741208,△741455
△ST741417,△741416,△741415
APPLICABLE CONNECTOR : MG655703
△APPLICABLE CLIP : 090II CLIP
- 6 HAZARDOUS SUBSTANCES IN PARTS (LEAD, MERCURY, CADMIUM, HEXAVALENT CHROMIUM, PBBs, PBDEs) SHALL NOT EXCEED THE MAXIMUM PERMISSIBLE CONCENTRATION PRESCRIBED UNDER EU ELV DIRECTIVE & RoHS REGULATION.

MG645751
MG646332

APPROVED	
2020-12-10	
KOREA ELECTRIC TERMINAL CO., LTD. Korea Electric Terminal Co., LTD.	
DIE NO	ISSUE MARK

ECO-1503-348	근거도면 변경	KTH	HYJ	LSY	15.03.18	MATERIAL	SEE TABLE	KET KOREA ELECTRIC TERMINAL CO., LTD.				
ECO-1411-061	근거도면 재작성	ASY	HYJ	LSY	14.11.06	FINISH	SEE TABLE					
ECO-1404-041	근거도면 재작성	RJH	KMH	CWK	14.04.04	WIRE RANGE						
ECO-1402-200	근거도면 재작성	RJH	KMH	CWK	14.02.24	INSULATION						
ECO-1311-076	근거도면 재작성	RJH	LSJ	CWK	13.11.12			TYPE	025/060/110/250			
LTR REVISION RECORD						DR	CHK	APP	DATE	TOLERANCE EXCEPT AS NOTED	SCALE	PART NO.
DR. JSY 2012.11.28						CHK.		APP. HSH 2012.11.28		SEE TABLE	1/1	MG645751
PART_NAME										025060110250 47M ASSY		

ECO-2004-076	근거도면 변경 (클립형 전선 터미널 용인 추가)	SKM	HYJ	CJH	20.04.03
ECO-2001-046	근거도면 변경 (적용 터미널 용인 추가)	SYS	WDH	CMS	20.01.06
ECO-1905-096	근거도면 변경 (CLIP 사용 추가)	SYS	WDH	CMS	19.05.08