

ISO VIEW

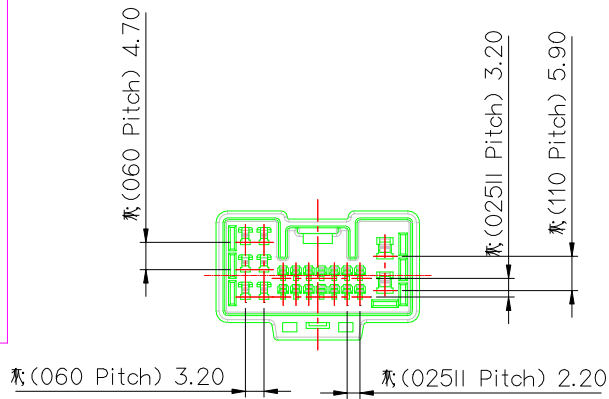

PITCH DETAIL

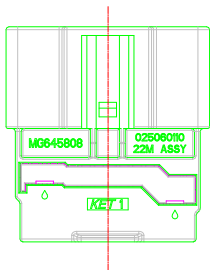
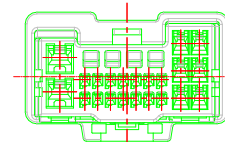
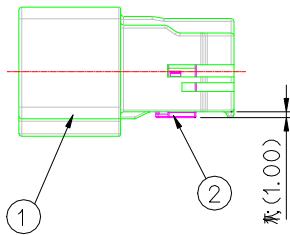
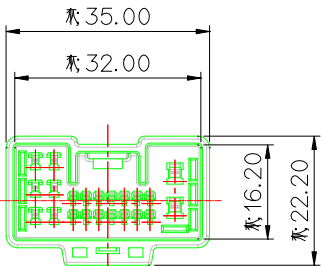
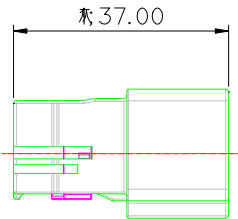
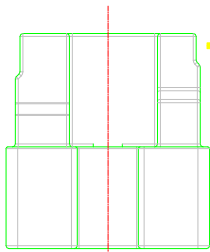

GENERAL TOLERANCE (HOUSING)

USED ON

10MAX	30MAX	50MAX	70MAX	100MAX	120MAX	250MAX	250VR	ANGLE	ECCENT	
±0.15	±0.2	±0.3	±0.4	±0.5	±0.75	±0.9	±1.4	±30'	0.1	

주 기

- 기능상 유해한 BURR 및 WELDLINE 등이 없을 것.
- 적용 TERMINAL(025II) : ST741345, 1346-3  
적용 TERMINAL(060) : ST741331, 1332, 1333-3  
적용 TERMINAL(110) : ST741285, 1286, 1287-3  
적용 CONNECTOR : MG655766
- 제품내 함유된 6대 유해물질 (납,수은,카드뮴,6가크롬, PBBs,PBDEs)은 EU ELV 지침 및 RoHS 법규에서 지정한 최대 허용 농도를 초과해서는 안된다.

NOTE

- MUST BE FREE OF FLASH, WELDLINE AND IMPERFECTION THAT AFFECT FUNCTION.  
APPLICABLE TERMINAL(025) : ST741345, 1346-3  
APPLICABLE TERMINAL(060) : ST741331, 1332, 1333-3  
APPLICABLE TERMINAL(110) : ST741285, 1286, 1287-3  
APPLICABLE CONNECTOR : MG655766
- 6 HAZARDOUS SUBSTANCES IN PARTS (LEAD, MERCURY, CADMIUM, HEXAVALENT CHROMIUM, PBBs, PBDEs) SHALL NOT EXCEED THE MAXIMUM PERMISSIBLE CONCENTRATION PRESCRIBED UNDER EU ELV DIRECTIVE & RoHS REGULATION.

APPROVED

2015-06-25

KOREA ELECTRIC  
TERMINAL CO., LTD.  
Connector Development Team 1

ISSUE MARK

NO.	PART NAME	PART NO.	MATERIAL	COLOR	QTY.
1	025060110 22M HOUSING	MG676099	PBT	NATURAL	1
2	025060110 22M SPACER	MG676101	PBT	L/GRAY	1

MATERIAL	SEE TABLE		KOREA ELECTRIC
FINISH	SEE TABLE		TERMINAL CO., LTD.
WIRE RANGE		CLASS	HYBRID
INSULATION		TYPE	025060110
LTR	REVISION RECORD	DR. CHK. APP. DATE	TOLERANCE EXCEPT AS NOTED
DR.	YTK. 2014.11.10	CHK.	SCALE 1/1
CHK.	KMH. 2014.11.10	APP. LSY. 2014.11.10	PART NO. MG645808
PART NAME			025060110 22M ASSY

