

GENERAL TOLERANCE (HOUSING)										USED ON
10 MAX	30 MAX	50 MAX	70 MAX	100 MAX	120 MAX	250 MAX	250 VR	ANGLE	ECCENT	
±0.15	±0.2	±0.3	±0.4	±0.5	±0.75	±0.9	±1.4	±30'	0.1	

- 주 기
- 가능상 유해한 BURR 및 WELDLINE 등이 없을 것,
 - 적용 TERMINAL(C025) : ST741360-3, ST741361-3
적용 TERMINAL(N110) : ST741367-3, ST741368-3,
ST741369-3
 - 적용 CLIP : MG631267, MG631929, MG633815, MG634834,
MG633862, MG633870, MG635682, MG663492
 - 적용 CONNECTOR : MG656949
 - 제품내 함유된 6대 유해물질 (납,수은,카드뮴,6가크롬,
PBBs,PBDEs)은 EU ELV 지침 및 RoHS 법규에서
지정된 최대 허용 농도를 초과해서는 안된다,

- NOTE
- MUST BE FREE OF BURR, WELDLINE AND IMPERFECTION THAT AFFECT FUNCTION,
 - APPLICABLE TERMINAL(C025) : ST741360-3, ST741361-3
APPLICABLE TERMINAL(N110) : ST741367-3, ST741368-3,
ST731369-3
 - APPLICABLE CLIP : MG631267, MG631929, MG633815, MG634834,
MG633862, MG633870, MG635682, MG663492
 - APPLICABLE CONNECTOR : MG656949
 - 6 HAZARDOUS SUBSTANCES IN PARTS (LEAD, MERCURY, CADMIUM, HEXAVALENT CHROMIUM, PBBs, PBDEs) SHOULD NOT EXCEED THE MAXIMUM PERMISSIBLE CONCENTRATION PRESCRIBED UNDER EU ELV DIRECTIVE & RoHS REGULATION

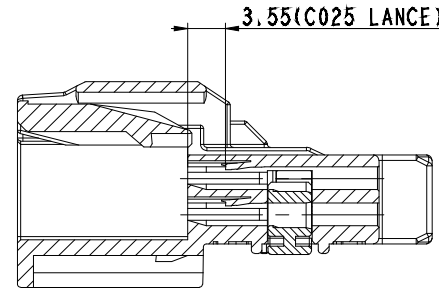

SECTION A-A

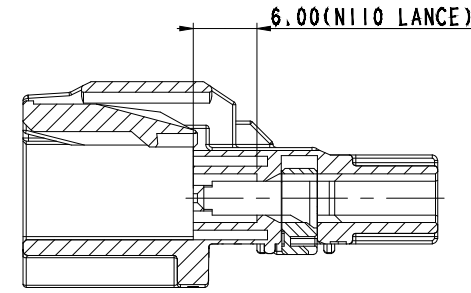

SECTION B-B

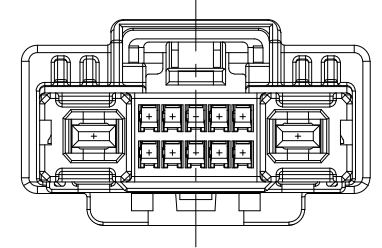

NO.	MATERIAL	COLOR
* 0	SEE TABLE	NATURAL
1		RED
11		ORANGE
2		BLUE
22		JADE
3		YELLOW
4		GRAY
41		LIGHT GRAY
42		DARK GRAY
5		BLACK
61		LIGHT GREEN
62		DARK GREEN
7		BROWN
9		MAGENTA

NO	PART NO.	PART NAME	MATERIAL	FINISH	Q'TY
1	MG676951	025110 12M HOUSING	PBT	SEE TABLE	1
2	MG676952	025110 12M SPACER	PBT	LIGHT GRAY	1

APPROVED

2019-11-05

**KOREA ELECTRIC
TERMINAL CO., LTD.
Korea Electric Te
rminal Co., LTD.**

ISSUE MARK

MATERIAL	SEE TABLE		KOREA ELECTRIC TERMINAL CO., LTD.				
FINISH	SEE TABLE						
WIRE RANGE	-			CLASS	HYBRID		
INSULATION	-	TYPE	C025 / N110				
LTR	REVISION RECORD	DR.	CHK.	APP.	DATE	SCALE	PART NO.
	DR. LJJ 2017.06.12	CHK. CKI 2017.06.12				2/1	MG646115
	CHK.	APP. LJE 2017.06.12	PART-NAME	025110 12M ASSY			