

GENERAL TOLERANCE (HOUSING)					USED ON
10MAX	20MAX	45MAX	ANGLE	ECCENT	
±0.2	±0.25	±0.3	±30'	0.1	

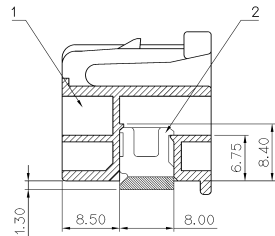
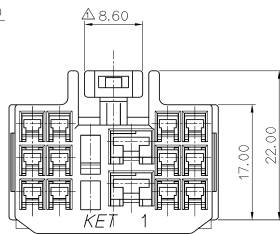

NOTE

- MUST BE FREE OF FLASH, SINK AND IMPERFECTION THAT AFFECT FUNCTION.
- APPLICABLE TERMINAL : ST730644, 645, 646(.187 TYPE: 2EA)  
ST730675 676, 677(.090 TYPE: 12EA)

주 기

- 제품기능상 유해한 BURR, 변형 및 WELDLINE 등이 없을것.
- 적용 TERMINAL: ST730644, 645, 646 (.187 TYPE: 2 EA)  
ST730675, 676, 677 (.090 TYPE: 12 EA)



ISSUE MARK

NO.	PART NO.	PART NAME	MATERIAL	COLOR
1	MG671377	1809 14P PLUG HOUSING	SEE TABLE	WHITE
2	MG671378	1809 14P PLUG SPACER		YELLOW

MATERIAL	PBT	KET KOREA ELECTRIC TERMINAL CO., LTD.	
FINISH	SEE TABLE		
WIRE RANGE	INSULATION	CLASS .090 II + .187 II	
LTR	REVISION RECORD	DATE	TYPE
DR. WCN. 99.01.13	CHK	DATE	PART NO. MG651379
CHK	APP. <i>Chen</i>	DATE	PART NAME 1809 14P PLUG HOUSING ASSEMBLY