

ISO VIEW

NOTE

- MUST BE FREE OF FLASH, WELDLINE AND IMPERFECTION THAT AFFECT FUNCTION.
- APPLICABLE TERMINAL(O25II) : ST731374,731375-3
 APPLICABLE TERMINAL(O60) : ST731334,731335,731336-3
 APPLICABLE TERMINAL(110) : ST731279,731280,731281-3
 APPLICABLE TERMINAL(250) : ST731209,731210,731211-3
 APPLICABLE CONNECTOR : MG645755
 APPLICABLE LEVER : MG635629
- 6 HAZARDOUS SUBSTANCES IN PARTS (LEAD,MERCURY, CADMIUM,HEXAVALENT CHROMIUM,PBBs,PBDEs) SHALL NOT EXCEED THE MAXIMUM PERMISSIBLE CONCENTRATION PRESCRIBED UNDER EU ELV DIRECTIVE & RoHS REGULATION.

△ GENERAL TOLERANCE (HOUSING)

10MAX	30MAX	50MAX	70MAX	100MAX	120MAX	250MAX	250VR	ANGLE	ECCENT	USED ON
±0.15	±0.20	±0.30	±0.40	±0.50	±0.75	±0.90	±1.4	±30'	0.1	

NO.	PART NAME	PART NO.	MATERIAL	COLOR	QTY.
1	025060110250 100F HOUSING	MG675880	PBT	BLACK	1
2	025060110250 100F SPACER	MG675881	PBT	YELLOW	2

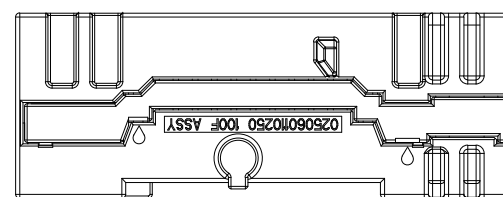
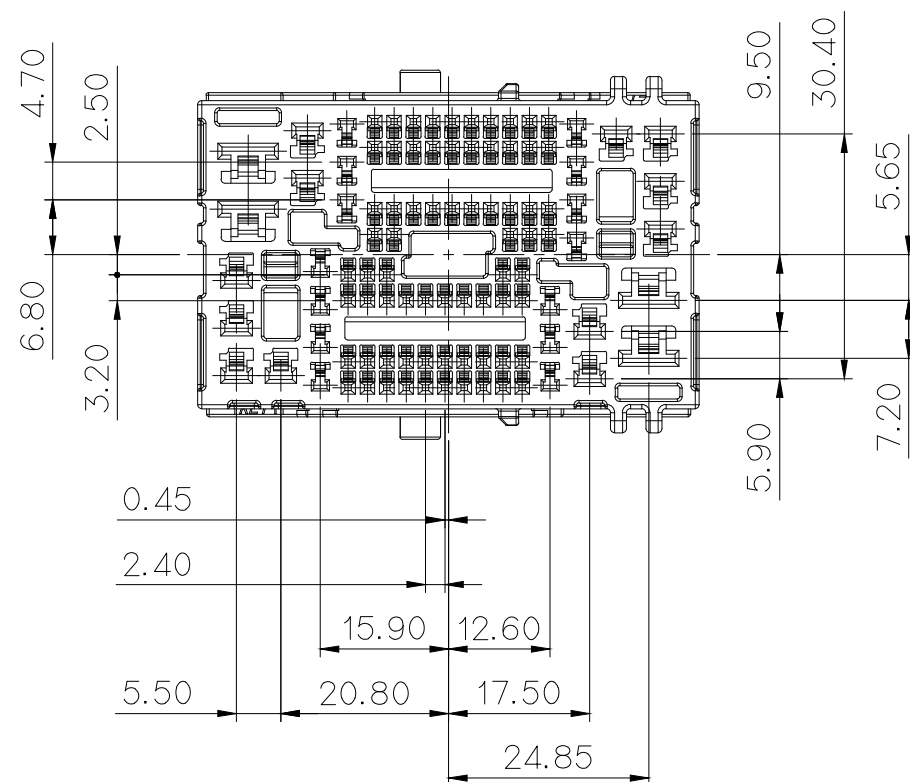
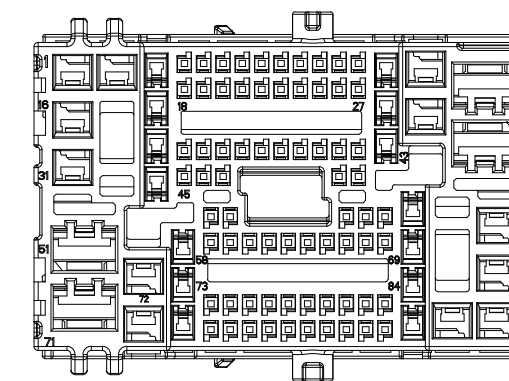
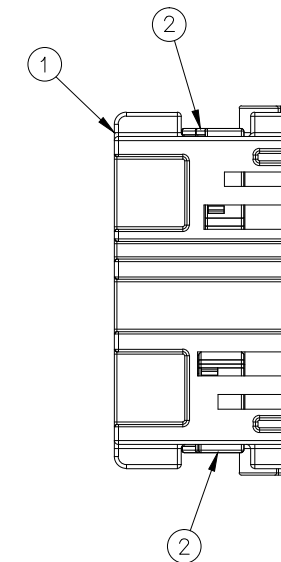
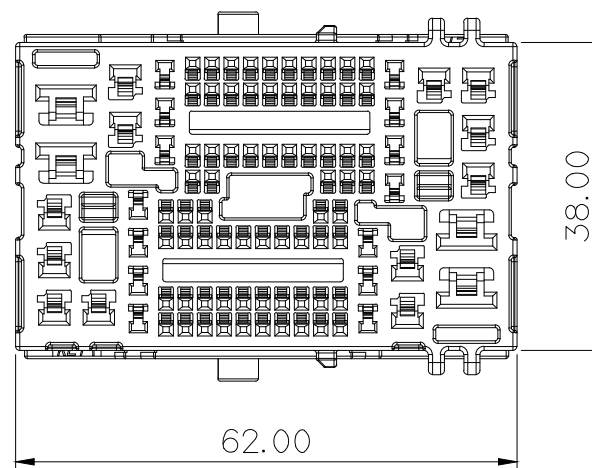
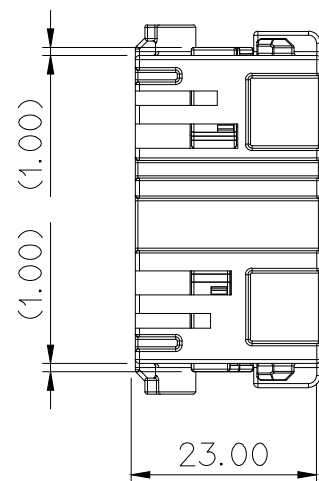

NO.	MATERIAL	COLOR
0	SEE TABLE	NATURAL
1		RED
2		BLUE
20		JADE
3		YELLOW
4		GRAY
40		DARK GRAY
41		LIGHT GRAY
△*		BLACK
6		DARK GREEN
7		BROWN
8		LIGHT GREEN
9		MAGENTA
11		ORANGE

주 기

- 기능상 유해한 BURR 및 WELDLINE 등이 없을 것.
- 적용 TERMINAL(O25II) : ST731374,731375-3
 적용 TERMINAL(O60) : ST731334,731335,731336-3
 적용 TERMINAL(110) : ST731279,731280,731281-3
 적용 TERMINAL(250) : ST731209,731210,731211-3
 적용 CONNECTOR : MG645755
 적용 LEVER : MG635629
- 제품내 함유된 6대 유해물질 (납,수은,카드뮴,6가크롬, PBBs,PBDEs)은 EU ELV 지침 및 RoHS 법규에서 지정한 최대 허용 농도를 초과해서는 안된다.

APPROVED

2016-02-26

KOREA ELECTRIC
 TERMINAL CO., LTD.
 Connector Development Team 1

ISSUE MARK

					MATERIAL	SEE TABLE	KOREA ELECTRIC TERMINAL CO., LTD.	
					FINISH	SEE TABLE		
					WIRE RANGE		CLASS	HYBRID
					INSULATION		TYPE	025/060/110/250
LTR	REVISION RECORD	DR.	CHK.	APP.	DATE	TOLERANCE EXCEPT AS NOTED	SCALE	PART NO.
						SEE TABLE	1/1	MG655701
DR.	SJK. 12.11.15	CHK.	HYJ		11.15	PART NAME	025060110250 100F ASSY	
CHK.	CWK 11.19	APP.	HSJ		11.19			