

ISO VIEW

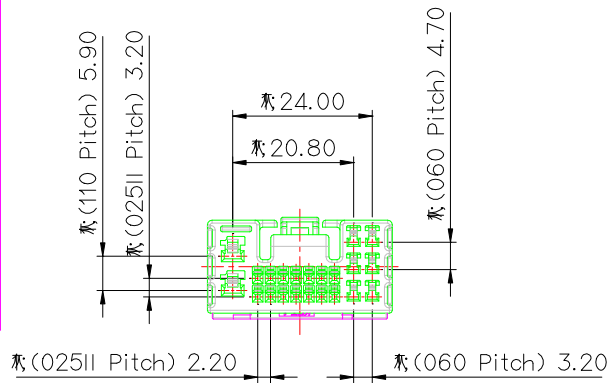

PITCH DETAIL

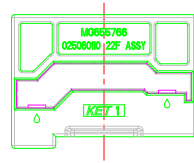
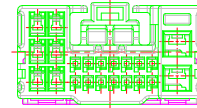
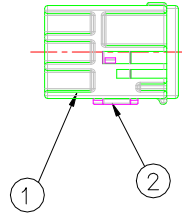
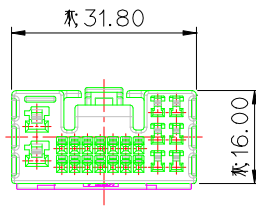
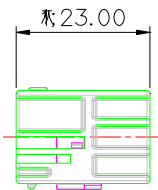
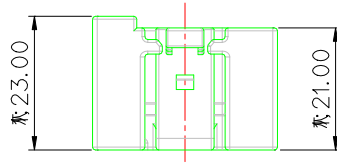

GENERAL TOLERANCE (HOUSING)

USED ON

10MAX	30MAX	50MAX	70MAX	100MAX	120MAX	250MAX	250VR	ANGLE	ECCENT	
±0.15	±0.2	±0.3	±0.4	±0.5	±0.75	±0.9	±1.4	±30'	0.1	

주 기

- 가능상 유해한 BURR 및 WELDLINE 등이 없을 것.
- 적용 TERMINAL(025II) : ST731374, 1375-3  
 적용 TERMINAL(060) : ST731334, 1335, 1336-3  
 적용 TERMINAL(110) : ST731279, 1280, 1281-3  
 적용 CONNECTOR : MG645808
- 제품내 함유된 6대 유해물질 (납,수은,카드뮴,6가크롬, PBBs,PBDEs)은 EU ELV 지침 및 RoHS 법규에서 지정한 최대 허용 농도를 초과해서는 안된다.

NOTE

- MUST BE FREE OF FLASH, WELDLINE AND IMPERFECTION THAT AFFECT FUNCTION.  
 APPLICABLE TERMINAL(025II) : ST731374, 1375-3  
 APPLICABLE TERMINAL(060) : ST731334, 1335, 1336-3  
 APPLICABLE TERMINAL(110) : ST731279, 1280, 1281-3  
 APPLICABLE CONNECTOR : MG645808
- 6 HAZARDOUS SUBSTANCES IN PARTS (LEAD, MERCURY, CADMIUM, HEXAVALENT CHROMIUM, PBBs, PBDEs) SHALL NOT EXCEED THE MAXIMUM PERMISSIBLE CONCENTRATION PRESCRIBED UNDER EU ELV DIRECTIVE & RoHS REGULATION.

APPROVED

2015-06-25

KOREA ELECTRIC  
 TERMINAL CO., LTD.  
 Connector Development Team 1

ISSUE MARK

NO.	PART NAME	PART NO.	MATERIAL	COLOR	QTY.
1	025060110 22F HOUSING	MG676098	PBT	NATURAL	1
2	025060110 22F SPACER	MG676100	PBT	YELLOW	1

MATERIAL	SEE TABLE	KOREA ELECTRIC TERMINAL CO., LTD.						
FINISH	SEE TABLE							
WIRE RANGE		CLASS HYBRID						
INSULATION		TYPE 025060110						
LTR	REVISION RECORD	DR.	CHK.	APP.	DATE	TOLERANCE EXCEPT AS NOTED	SCALE 1/1	PART NO. MG655766
DR.	YTK. 2014.11.10	CHK.						
CHK.	KMH. 2014.11.10	APP.	LSY. 2014.11.10					
PART NAME							025060110 22F ASSY	