

GENERAL TOLERANCE (HOUSING)										USED ON
10 MAX	30 MAX	50 MAX	70 MAX	100 MAX	120 MAX	250 MAX	250 VR	ANGLE	ECCENT	
±0.15	±0.2	±0.3	±0.4	±0.5	±0.75	±0.9	±1.4	±30'	0.1	

NO	PART NO.	PART NAME	MATERIAL	FINISH	Q'TY
1	MG677494	025 27F HOUSING RSB(FAKRA)	PBT	BLUE	1
2	MG677495	025 27F SPACER RSB(FAKRA)	PBT	NATURAL	1

- 주 기
1. 기능상 유해한 BURR 및 WELDLINE 등이 없을 것.
  2. 제품내 함유된 6대 유해물질 (납,수은,카드뮴,6가크롬, PBBs,PBDEs) 은 EU ELV 지침 및 RoHS 법규에서 지정한 최대 허용 농도를 초과해서 는 안된다.
  3. 적용 TERMINAL(C025): ST731409, ST731410  
적용 TERMINAL(ROSENBERGER FAKRA):  
59K130-1M4A4, 59K130-102A4 (2세대)  
59K16B-1M4T4, 59K16B-102T4 (3세대)

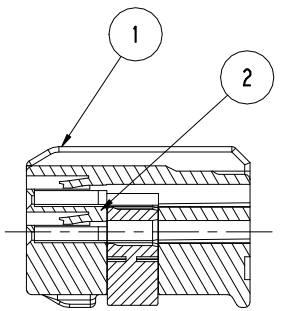

SECTION A-A

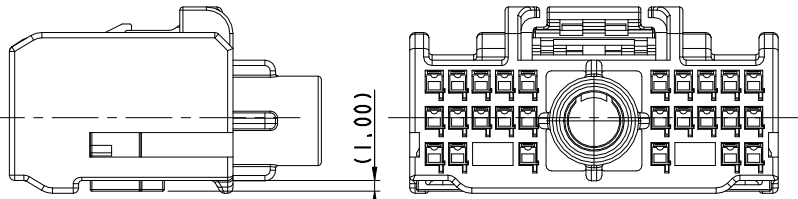

- NOTE
1. MUST BE FREE OF FLASH, WELDLINE AND IMPERFECTION THAT AFFECT FUNCTION.
  2. 6 HAZARDOUS SUBSTANCES IN PARTS (LEAD, MERCURY, CADMIUM, HEXAVALENT CHROMIUM, PBBs, PBDEs) SHALL NOT EXCEED THE MAXIMUM PERMISSIBLE CONCENTRATION PRESCRIBED UNDER EU ELV DIRECTIVE & RoHS REGULATION.
  3. APPLICABLE TERMINAL(C025): ST731409, ST731410  
APPLICABLE TERMINAL(ROSENBERGER FAKRA):  
59K130-1M4A4, 59K130-102A4 (2th Generation)  
59K16B-1M4T4, 59K16B-102T4 (3th Generation)

NO.	MATERIAL	COLOR
0	P B T	NATURAL
1		RED
11		ORANGE
* 2		BLUE
22		JADE
3		YELLOW
4		GRAY
41		LIGHT GRAY
42		DARK GRAY
5	BLACK	
61	LIGHT GREEN	
62	DARK GREEN	
7	BROWN	
9	MAGENTA	

ISSUE MARK

MATERIAL	SEE TABLE	<b>KET</b> KOREA ELECTRIC ENGINEERED TERMINAL CO., LTD.
FINISH	SEE TABLE	
WIRE RANGE	-	CLASS C025 / RSB FAKRA
INSULATION	-	TYPE NON WP
LTR REVISION RECORD	DR. / CHK. / APP. / DATE	TOLERANCE EXCEPT AS NOTED
DR. KTK 19.05.23	CHK. LJJ 19.05.23	SCALE 2/1
CHK. AJH 19.05.23	APP. CMS 19.05.23	PART NO. MG657100
PART-NAME		025 27F ASSY RSB(FAKRA)