

CUSTOMER DRAWING

PART NO. SEE TABLE

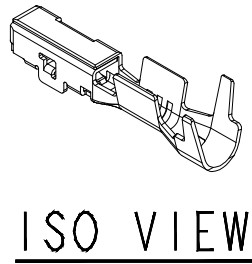

ISO VIEW

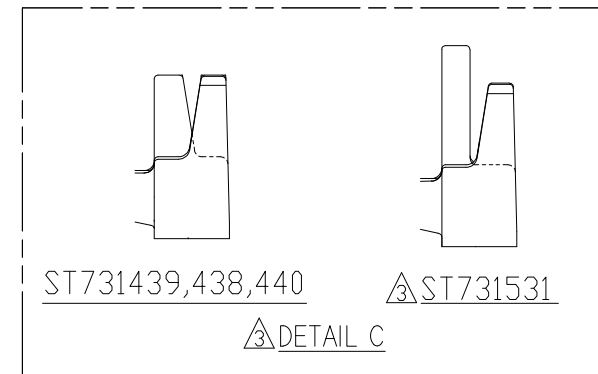
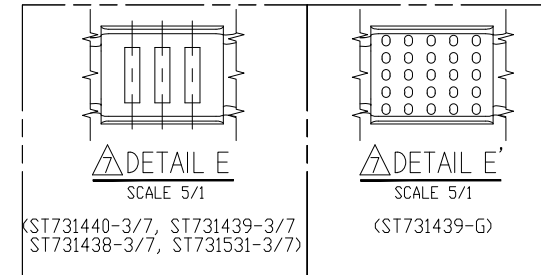
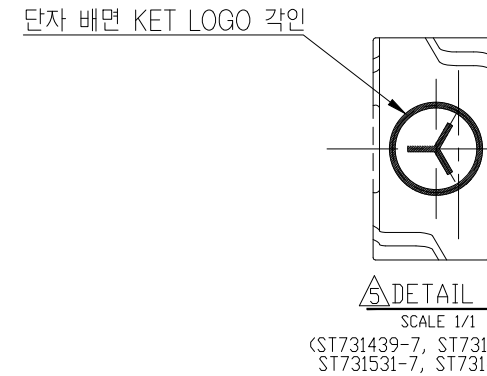
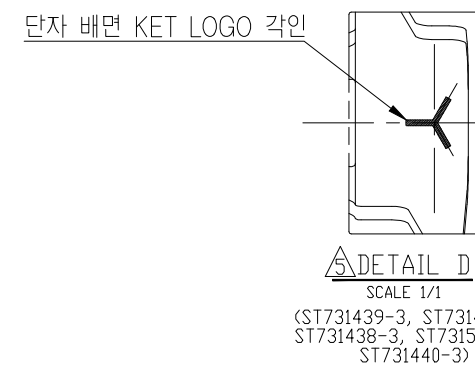
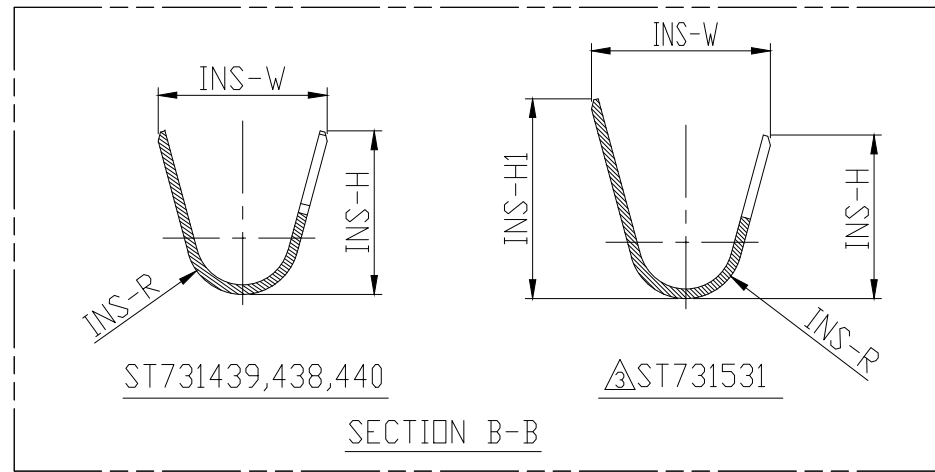
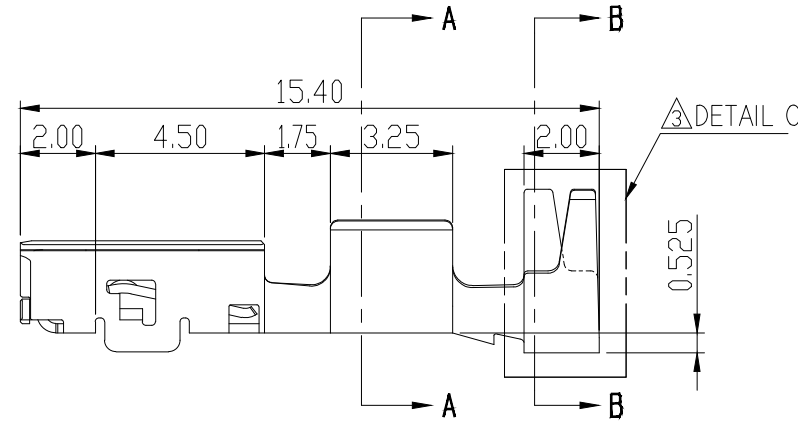
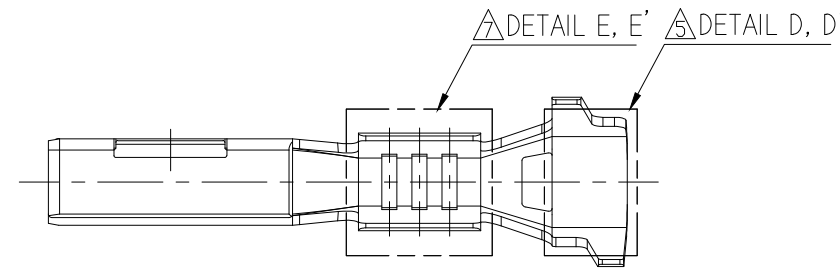
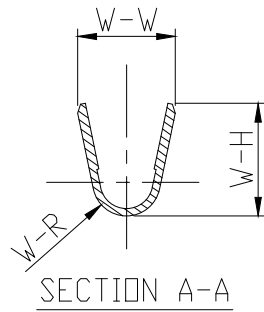
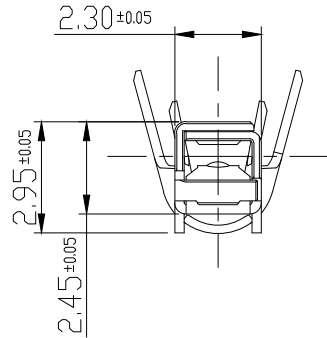

GENERAL TOLERANCE (TERMINAL)					USED ON
10 MAX	20 MAX	45 MAX	ANGLE	ECCENT	
±0.2	±0.3	±0.55	±30'	0.1	

- 주요  
 1. 지시없는 C, R=0.30으로 한다.  
 2. 가능한 유해한 흠, 변형 및 BURR가 없을 것  
 3. 적용 상대 TAB TERMINAL : ST741375-3, ST741375-7, ST741376-3, ST741376-G, ST741376-7, ST741439-3, ST741439-7, ST741377-3, ST741377-7  
 4. 제품내 함유된 6대 유해물질 (납, 수은, 카드뮴, 6가크롬, PBBs, PBDEs)은 EU ELV 지침 및 RoHS 법규에서 지정한 최대 허용 농도를 초과해서는 안된다.  
 5. \* 전선사양 적용 시 사용 환경 고려할 것. (EX. 온도조건)  
 6. WIRE INSULATION RANGE는 STANDARD 외경치수 기준.  
 7. 신뢰성 내구평가 시 적용전선의 온도등급 기준으로 적용할 것  
 8. 전선 범위 이외의 전선 적용 시 공급자에 확인 후 적용할 것

- NOTES  
 1. UNLESS OTHERWISE SPECIFIED ALL RADIUS TO BE 0.3 RADIUS AND CHAMFER.  
 2. MUST BE FREE OF BURR, CRACK AND IMPERFECTION THAT AFFECT FUNCTION.  
 3. APPLICABLE TAB TERMINAL : ST741375-3, ST741375-7, ST741376-3, ST741376-G, ST741376-7, ST741439-3, ST741439-7, ST741377-3, ST741377-7  
 4. 6 HAZARDOUS SUBSTANCES IN PARTS (LEAD, MERCURY, CADMIUM, HEXAVALENT CHROMIUM, PBBs, PBDEs) SHOULD NOT EXCEED THE MAXIMUM PERMISSIBLE CONCENTRATION PRESCRIBED UNDER EU ELV DIRECTIVE & RoHS REGULATION.  
 5. \* WHEN APPLYING WIRE SPECIFICATIONS, CONSIDER THE USE ENVIRONMENT. (EX. TEMPERATURE CONDITION)  
 6. WIRE INSULATION RANGE IS BASED ON STANDARD OUTER DIAMETER.  
 7. WHEN RELIABILITY DURABILITY TEST, IT IS APPLIED BASED ON THE TEMPERATURE CLASS OF THE APPLIED WIRE.  
 8. CHECK WITH THE SUPPLIER BEFORE APPLYING IT, WHEN APPLYING TEMPERATURE CLASS OF THE APPLIED WIRE.

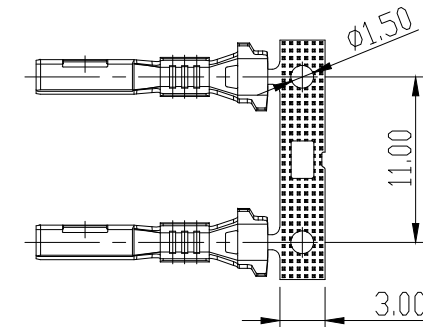

C060 WP FEMALE TML  
SCALE 2/1

NO	PART NO	PART NAME	W-R	W-W	W-H	INS-R	INS-W	INS-H	INS-HI	*) WIRE RANGE	INSULATION RANGE	WIRE SEAL
1	ST731440-3/-7	C060 WP FEMALE TML(S)	0.60	1.90	2.05	1.50	4.50	4.35	-	AESSXF 0.22sq	1.2-1.3	-
2	ST731439-3/-7	C060 WP FEMALE TML(M)	0.75	2.40	2.30	1.50	4.50	4.35	-	AVSSXF, AESSXF 0.3-0.5sq CIVUS 0.5sq FLR2X-A,B 0.35-0.5sq	1.1-1.34	MG685570
3	ST731439-G	C060 WP FEMALE TML(M)_Au	0.75	2.40	2.30	1.50	4.50	4.35	-	PFA WIRE 0.3sq, CIVUS 0.35sq AVSSXF, AESSXF 0.3-0.5sq CIVUS 0.5sq FLR2X-A,B 0.35-0.5sq	1.1-1.34	MG685570
4	ST731438-3/-7	C060 WP FEMALE TML(L)	1.00	3.20	2.90	1.50	4.50	4.35	-	CIVUS 0.75-1.0sq AVSSXF, AESSXF 0.75-1.25sq, FLR2X-B 0.75-1.0sq	1.2-1.75	MG685513
5	ST731531-3/-7	C060 WP FEMALE TML(XL)	1.00	3.35	3.00	1.50	5.00	4.35	5.25	CIVUS 1.0sq FLR2X-A,B 1.0-1.5sq	1.2-1.75	MG685513

ECO-2103-057	근거 도면 재작성	JKH	CKY	21.03.31	
ECO-2012-282	세경화 ISO 전선 사양 도면 추가	YTK	CKY	20.12.18	
ECO-2009-407	저마찰 도금 사양 추가	LJH	CKY	20.10.06	
ECO-2006-116	금도금 사양 개발	SSW	CKY	20.06.15	
ECO-1906-205	1.5Sq Modify 개발	JKH	CKY	19.07.01	
ECO-1904-274	적용 WIRE RANGE 변경	SSW	CKY	19.04.16	
ECO-1805-400	적용 WIRE SEAL 사양추가	LJH	SUK	18.05.29	
ECO-1703-099	양산도면 출도	PSJ	K.H	17.03.07	
LTR	REVISION RECORD	DR.	CHK.	APP.	DATE
DR. PSJ	17.03.07	CHK			
CHK. WSW	17.03.07	APP. K.H		17.03.07	

MATERIAL	Copper Alloy	KETA ENGINEERED	KOREA ELECTRIC TERMINAL CO., LTD.
FINISH	PRE-TIN		
WIRE RANGE	SEE TABLE	CLASS	C060
INSULATION	SEE TABLE	TYPE	WP
TOLERANCE EXCEPT AS NOTED	SEE TABLE	SCALE	5/1
PART_NO.	SEE TABLE	PART_NAME	C060 WP FEMALE TERMINAL(M,L,XL)

APPROVED

2021-10-21

KOREA ELECTRIC  
TERMINAL CO., LTD.  
Korea Electric Terminal Co., LTD.

ISSUE MARK

(DIMENSIONS IN MM)